

Blind flange X PN 10 and ductile iron PN 10/16

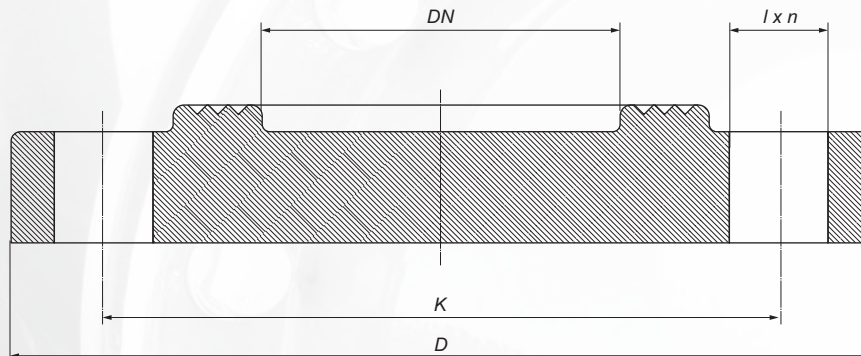

It is used to blind a water supply systems.

Coating: bitumen paint, epoxy paint 250-360 μm
Material: cast iron EN-GJL-250, PN-EN 1561:2000
Flange connection: PN-EN 1092-2:1999
Nominal pressure: 1,0 MPa; PN 10

| DN | K | D | l | n | Weight |
|-----|-----|-----|----|-------|--------|
| 50 | 125 | 165 | 18 | 4 | 2,20 |
| 80 | 160 | 200 | 18 | 4 (8) | 3,00 |
| 100 | 180 | 220 | 18 | 8 | 3,80 |
| 150 | 240 | 285 | 22 | 8 | 6,60 |
| 200 | 295 | 340 | 22 | 8 | 10,50 |
| 250 | 350 | 400 | 22 | 12 | 16,00 |
| 300 | 400 | 445 | 22 | 12 | 22,50 |

Coating: epoxy paint 250-360 μm
Material: ductile iron, EN-GJS-500-7, PN-EN 1563:2000
Flange connection: PN-EN 1092-2:1999
Nominal pressure: 1,0/1,6 MPa; PN 10/16

| DN | K | D | l | n | Weight |
|-----|----------|-----|--------|-------|--------|
| 50 | 125 | 165 | 18 | 4 | 2,40 |
| 65 | 145 | 185 | 18 | 4 | 3,20 |
| 80 | 160 | 200 | 18 | 8 | 3,90 |
| 100 | 180 | 220 | 18 | 8 | 4,80 |
| 125 | 210 | 250 | 18 | 8 | 6,20 |
| 150 | 240 | 285 | 22 | 8 | 8,10 |
| 200 | 295 | 340 | 22 | 8(12) | 11,40 |
| 250 | 350(355) | 400 | 22(26) | 12 | 16,60 |
| 300 | 400(410) | 445 | 22(26) | 12 | 23,50 |